

PESF-U401B2-30

1. Mechanical Dimension: (mm)

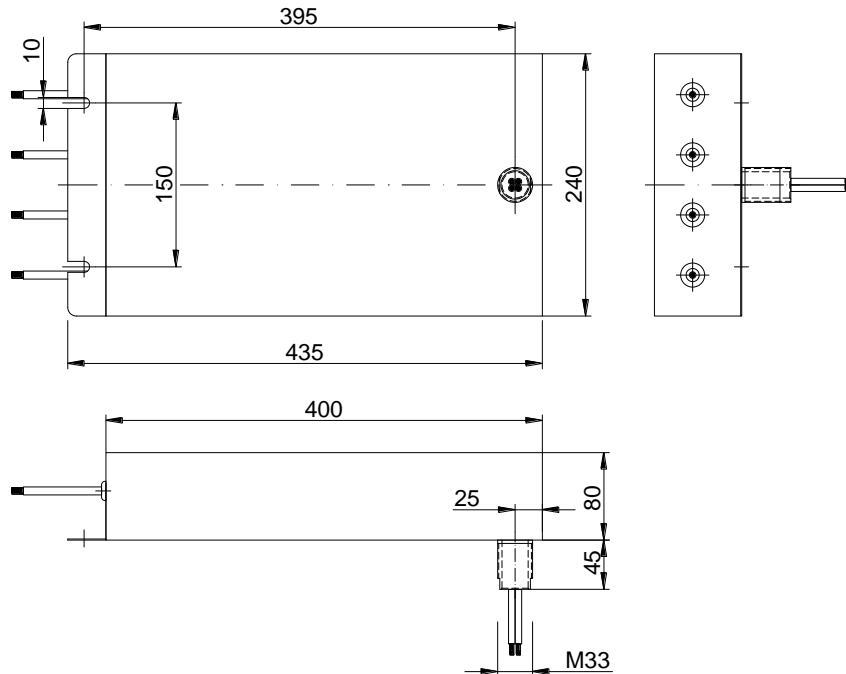

2. Technical Data:

Rated Voltage: 440/250VAC

Operating Frequency: 50/60Hz

Rated Current: 30A

Insertion Loss: ≥ 100 dB (100KHz ~ 18GHz)

Climatic Category: 25/070/21

- 3. Accessories:**
- | | |
|--------------------|-------------------|
| ① M33 Conduit: 1PC | ② Gasket 33: 1PC |
| ③ M33 Nut: 1PC | ④ Wire Mesh: 2 PC |

4. Installation Drawing:

